

Nand Vatika greens

Bariatu, Ranchi

PLATINUM RATED SOCIETY
from IGBC (Indian Green Building Council)

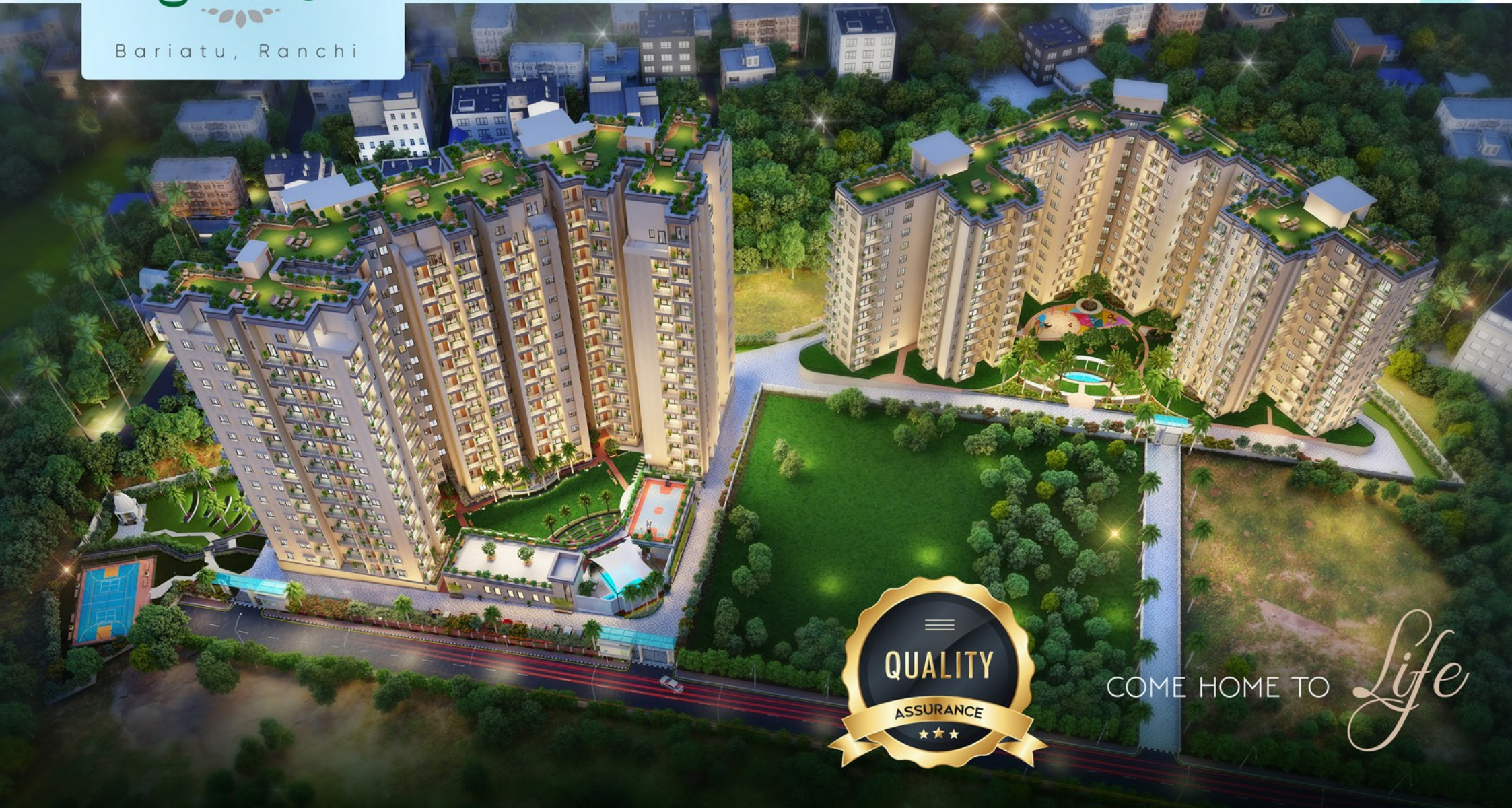

COME HOME TO *Life*

SALIENT *Features*



3 Side Open
Apartments



67% Open Space
of which 80% is Landscape



Vastu Compliant
All flats and the premises



Common Area Lighting
From Hybrid Solar System



250+ Oxygen Enriching Plants
across the entire boundary



Gated & Gaurded Complex
In Fully Secured Campus



Visitor Car Parking



Drip Irrigation System
in Garden Area



Electric Charging Points
in Parking (For All 4-wheelers
and 2-wheelers)

A spacious yet affordable home. Staying in nature's lap with fun amenities to fill your leisure hours in a location that keeps you connected to every part of your city. At **Nand Vatika Greens** all these little luxuries of urban life comes together to give you the fine living experience you've been dreaming of all along! The leisurely amenities have been designed for the urban soul in need of a rejuvenating break from all the hustle bustle of life. Dive into these luxuries and come out more refreshed than ever before!



 Live the Dream in a Truly Urban Highrise!

Step into the life extraordinaire at Nand Vatika Greens ! Within the walls of this modern high rise lies a truly distinctive world filled with every comfort, leisure and convenience you have ever wanted. Come home to the life of your dreams!

- **Asthetical Design Maintaining Natural Beauty Of The Area**
- **Designed to Utilise Maximum Daylight And Natural Air To Reduce Overall Electricity Consumption**



FLOOR

Plans



BLOCK A

TYPICAL 1ST TO 12TH FLOOR

FLAT NO.	FLAT A 101 - 1201	FLAT A 102 - 1202
RERA CARPET AREA	1395 SQFT	1173 SQFT
BUA	1745 SQFT	1423 SQFT
ACTUAL SBUA	2235 SQFT	1825 SQFT

FLAT NO.	FLAT A 103 - 1203	FLAT A 104 - 1204
RERA CARPET AREA	613 SQFT	973 SQFT
BUA	825 SQFT	1209 SQFT
ACTUAL SBUA	1058 SQFT	1548 SQFT

FLAT NO.	FLAT A 105 - 1205	FLAT A 106 - 1206
RERA CARPET AREA	1013 SQFT	947 SQFT
BUA	1264 SQFT	1146 SQFT
ACTUAL SBUA	1618 SQFT	1467 SQFT

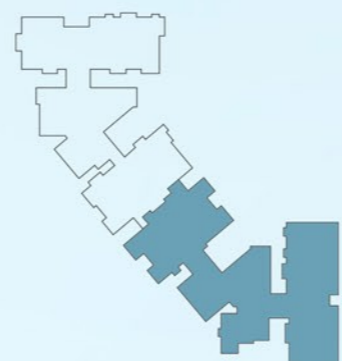

TYPICAL 1ST TO 12TH FLOOR

FLAT NO.	FLAT B 101 - 1201	FLAT B 102 - 1202
RERA CARPET AREA	1439 SQFT	1181 SQFT
BUA	1801 SQFT	1416 SQFT
ACTUAL SBUA	2320 SQFT	1815 SQFT

FLAT NO.	FLAT B 103 - 1203	FLAT B 104 - 1204
RERA CARPET AREA	655 SQFT	1036 SQFT
BUA	854 SQFT	1264 SQFT
ACTUAL SBUA	1095 SQFT	1618 SQFT

FLAT NO.	FLAT B 105 - 1205	FLAT B 106 - 1206
RERA CARPET AREA	1064 SQFT	846 SQFT
BUA	1269 SQFT	1054 SQFT
ACTUAL SBUA	1625 SQFT	1350 SQFT



BLOCK B

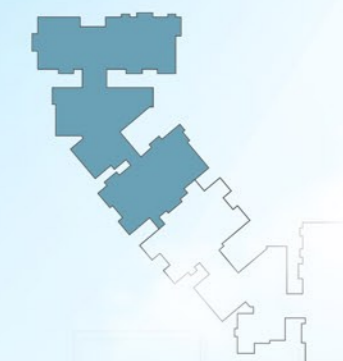

LEISURE

Amenities

Leaves of happiness, flowers of wellness. Isn't it amazing how mother nature works like a doctor... surrounded by greens, you feel healthier. You become active and fitter. It takes your child away from the television towards sports. Don't just watch... join the game.



Community Hall



Party Hall



Toddler Playing Zone With Parents Lounge



Indoor Games Area (Carram, Table Tennis, Pool Table, Fuss Ball, Card Rooms)

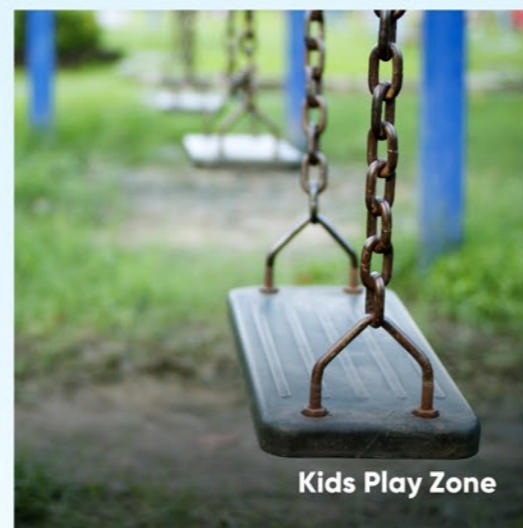

Kids Play Zone

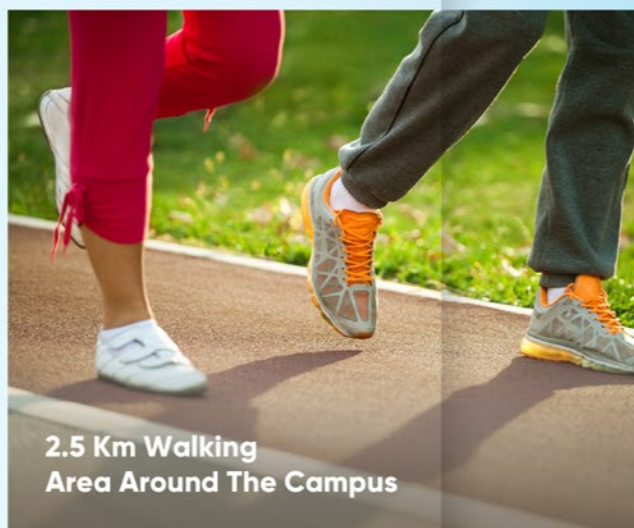

2.5 Km Walking Area Around The Campus



4- Seasons Swimming Pool With Changing Room



Multi Purpose Court (Basket Ball Court, Lawn Tennis Court, Volleyball Court)

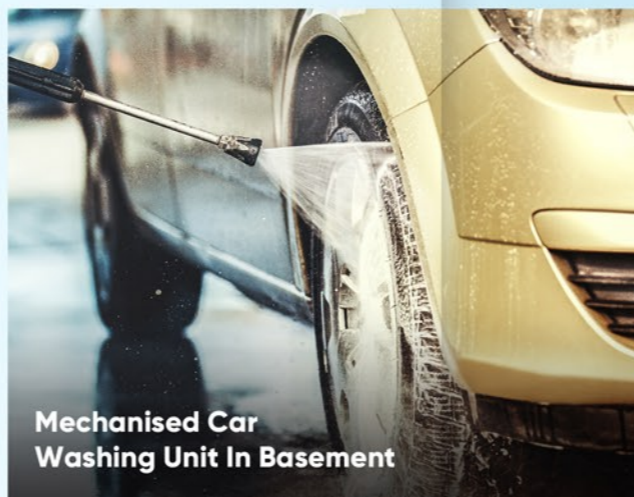

Mechanised Car Washing Unit In Basement

OTHER SPECIAL

Facilities

- 8 Guest Rooms With Pantry (For Use Of Society Members As Per Need)
- Reading Room
- Separate Rooms & Washrooms For Servants On Each Floor
- Free Body Exercise Tools in Open Garden Area
- Concierge
- Sitting Gajabo's on the Top of Community Hall & Terrace
- Design for Easy & Convenient Access of Physically Disabled
- Sewage treatment plant with dual plumbing system do reduce water wastage more than 50%



TRAVEL LESS

Everyday

KEY DISTANCES

- Birla Hanuman Mandir - **500 Mtrs**
- Surendranath Public School - **1.4 Kms**
- DAV Public School - **1.4 Kms**
- Bank of India - **1.4 Kms**
- RIMS Hospital - **1.5 Kms**
- State Bank of India - **1.8 Kms**
- Cheshire Home - **1.2 Kms**
- Khelgan Chowk - **2.0 Kms**
- Don Bosco church - **2.6 Kms**
- Khadgara Bus stand - **5 Kms**
- Ranchi Railway station - **6.3 Kms**
- Birsa Manda Airport - **10 Kms**



LOCATION MAP

DEVELOPERS

NAND VATIKA DEVELOPERS PVT. LTD
 Ranjan Kumar Fogla - **9431103608**
 Aman Fogla - **7909049160**
 Nand Vatika Society, Joda Talab Road,
 Bariatu, Ranchi
Email: nvdpl19122020@gmail.com

RERA Details

JHARERA/PROJECT/58/2022

PROJECT ARCHITECTS

Axis Architects, Ranchi
 Pincipal Architect - Ar. Sandeep Kr. Jha.

STRUCTURAL ENGINEERS

Adroit Consultant
 Mainak Majumdar

SITE ADDRESS

Nand Vatika Greens
 Nand Vatika Society,
 Beside Birla Hanuman Mandir,
 Joda Talab - Cheshire Home Road,
 Bariatu, Ranchi - 834009

HOUSING LOAN APPROVALS



DISCLAIMER

This brochure is not a legal document. It describes the conceptual plan to convey the intent and purpose of **Nand Vatika Greens**. The images are imaginary and the details mentioned in this brochure are tentative and subject to change at the sole discretion of the developer and /or architects.

